

**Captivate™ Series  
Bookcase to  
Entertainment  
Cabinet Ganging**

**Recommended Tools**

- Power Drill
- Phillips Screw Bit

**Package Contents**

- #8 x 1 ¼" Flathead Screws

**NATIONAL**

Furniture with Personality®

Telephone 800.482.1717  
Fax 812.482.8800  
www.nationalonline.com

Part #2040764

Printed in U.S.A  
© 2007 Kimball International, Inc.

Figure A

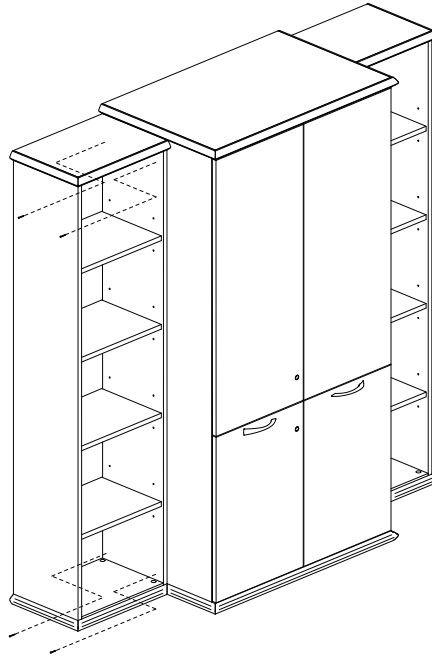

**1**

**Ganging Units**

A bookcase may be "ganged" to each side of an entertainment cabinet.

**Note:** All floor units and base units MUST be leveled.

**2**

Fasten units together using the #8 x 1 ¼" screws provided. Use a minimum of four (4) screws at the widest spacing possible to achieve the strongest and most stable assembly.

**Recommended:** Pre-drill pilot hole and countersink through bookcase prior to installing.

Proper product installation, in accordance with these instructions, is the responsibility of the installing agent. If you have any questions concerning these instructions, please call National Customer Service.